

↪ Flip over and decorate the skies! ↪

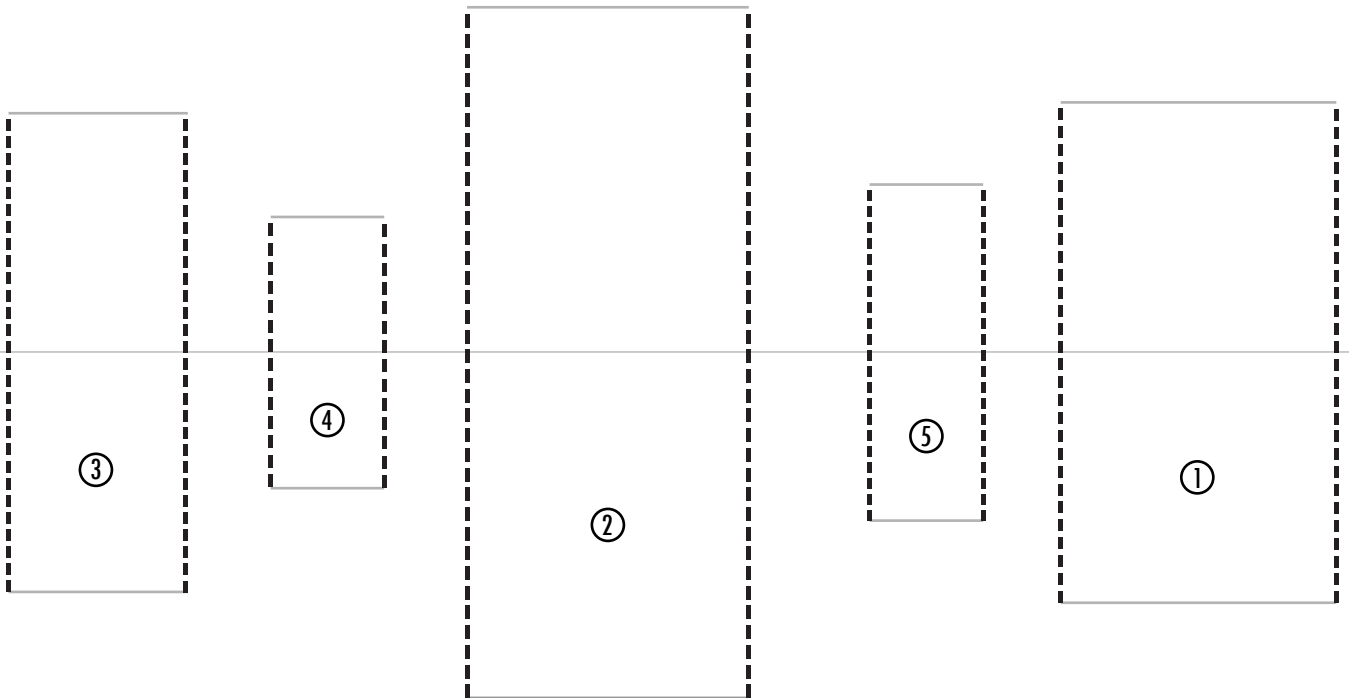

INSTRUCTIONS - PART 1

1. Print out this page on your paper of choice.
2. Flip over to the plain side of the paper (without any lines), and draw and colour the skies of Singapore - the sky's the limit!
3. Once done, cut this Instructions slip and remove. Keep for reference.

4. Fold paper along the middle grey line with the rectangular box lines facing outward (the coloured sky portion should be facing down).
5. Cut along the dotted lines of the folded paper.
6. Open the paper, and push all the cut folds outward.
7. Fold down the solid lines to make them sturdy.
8. Then, fold the paper in half again and press down.
9. Open the folded paper - the coloured sky portion should be facing front.

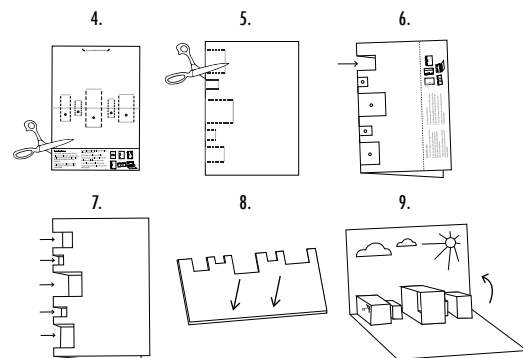

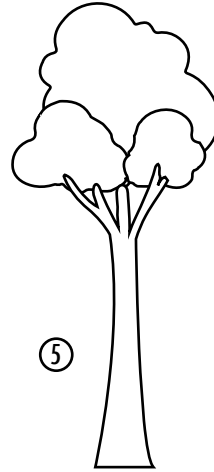
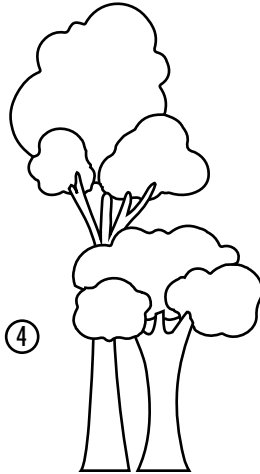
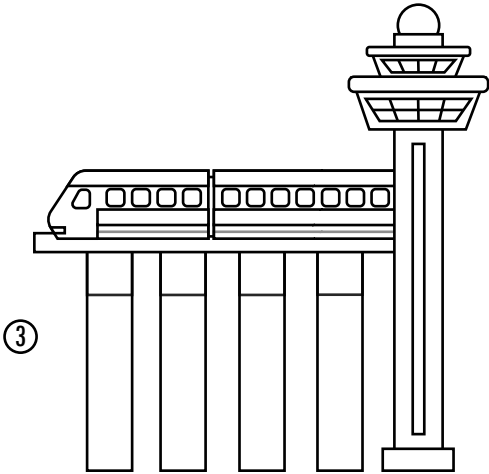
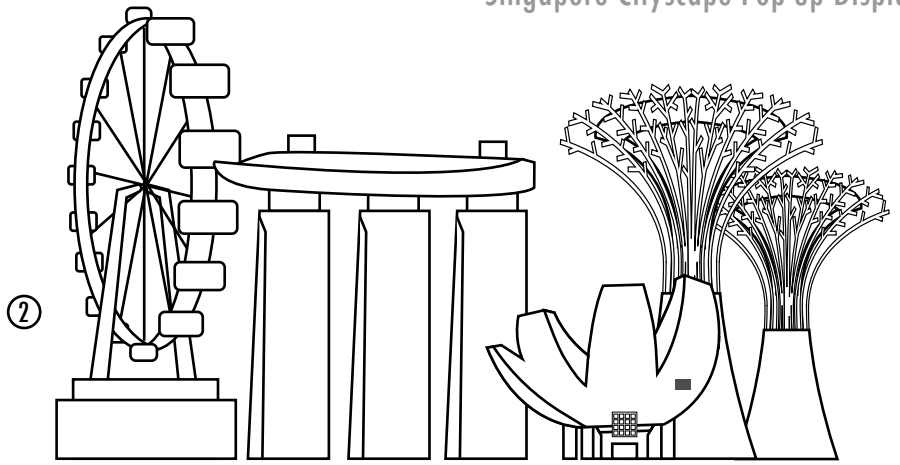
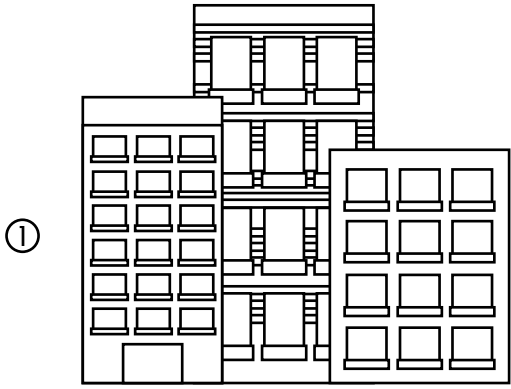

INSTRUCTIONS - PART 2

10. Colour each iconic building/monument of Singapore. (Figure 1, 2, 3 + Trees 4 & 5)

11. Cut out Figure 1 to 5.

12. Refer to Activity Sheet 1, paste cut-outs according to the number at the back of the folds.

INSTRUCTIONS - PART 3

13. Imagine what Singapore would be like in the year 2065. Draw your version of future buildings or transportation in the boxes provided on the left - be creative!

14. Cut out the drawings (Figure 6 to 9) and the pop-up stand strips below.

a. To assemble pop-up stand, fold solid lines inward and glue A to B to create a cube-like structure.

b. To attach stand with drawings, apply glue on the back of paper and paste.

